



Apartment 3409 10 Park Drive, London, E14 9QY

£1,500 Per week

 2
  2
  1
  B

A beautifully furnished 2-bedroom, 2-bathroom apartment at 10 Park Drive offers approximately 103.49 sq m (1,114 sq ft) of contemporary riverside living.

The bright, open-plan reception, dining area, and fully fitted kitchen with island are perfect for entertaining, while the west-facing terrace provides a private outdoor retreat. The master bedroom features a dressing area, en-suite, and private balcony, with a second double bedroom also offering an en-suite/guest bathroom. Photos have been digitally dressed for marketing purposes.

Residents benefit from 24-hour concierge, a residents' lounge and terrace, and exclusive access to Third Space gym and wellness facilities. Located less than a mile from Canary Wharf and 0.4 miles from Westferry DLR, with Limehouse and Victoria Park nearby, this stylish home combines luxury, convenience, and comfort.

Council Tax Band: F
Minimum contract: 12 months
Change of contract fee: £50 including VAT
Holding Deposit - £1,500 - 1 weeks rent, subject to agreed offer

Electricity supply – Mains | Heating, Hot Water – Communal supply | Water Supply & Sewerage – Mains | Lift Access
To check broadband and mobile phone coverage please visit Ofcom

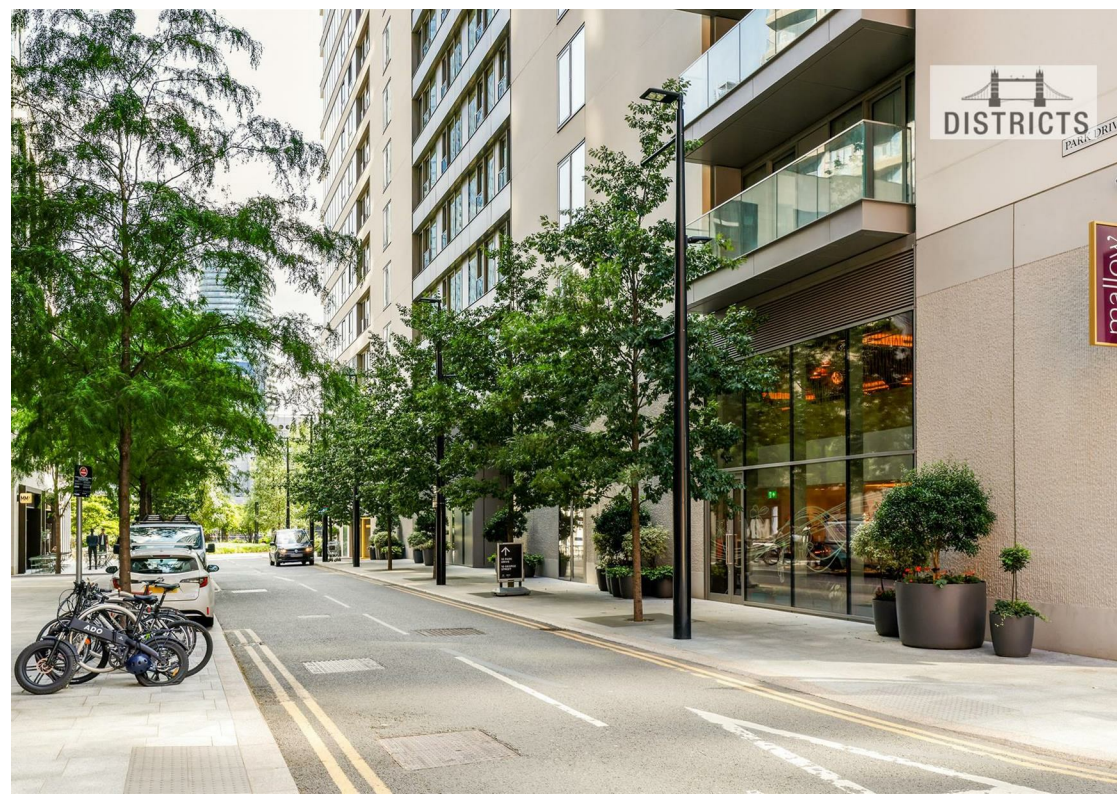
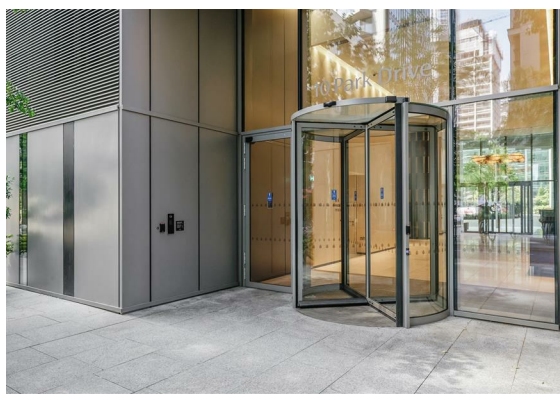



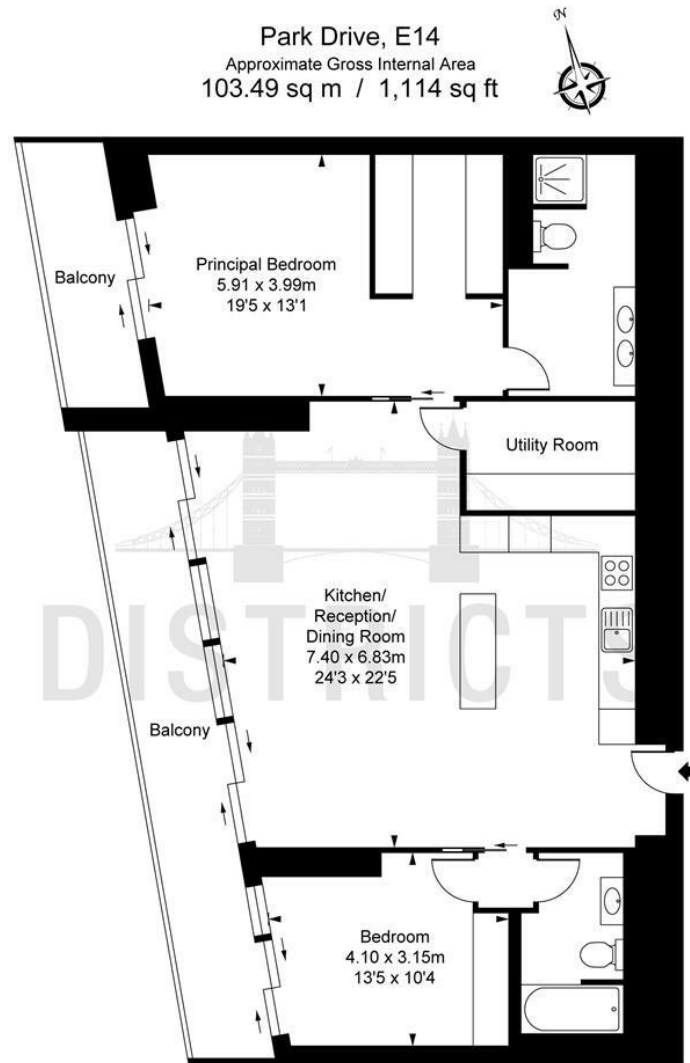

| Energy Efficiency Rating | | |
|---|-----------|----------------------------|
| | Current | Potential |
| Very energy efficient - lower running costs | | |
| (92 plus) A | | |
| (81-91) B | 86 | 86 |
| (69-80) C | | |
| (55-68) D | | |
| (39-54) E | | |
| (21-38) F | | |
| (1-20) G | | |
| Not energy efficient - higher running costs | | |
| England & Wales | | EU Directive 2002/91/EC |

These particulars, whilst believed to be accurate are set out as a general outline only for guidance and do not constitute any part of an offer or contract. Intending purchasers should not rely on them as statements of representation of fact, but must satisfy themselves by inspection or otherwise as to their accuracy. No person in this firm's employment has the authority to make or give any representation or warranty in respect of the property.